

# Reservoir By Pass Chamber

Metal Lockable H-Cover 110 x110 cm  
Sheet: 3mm thickness  
Frame: Angel-iron(50x50x3)mm with inside support

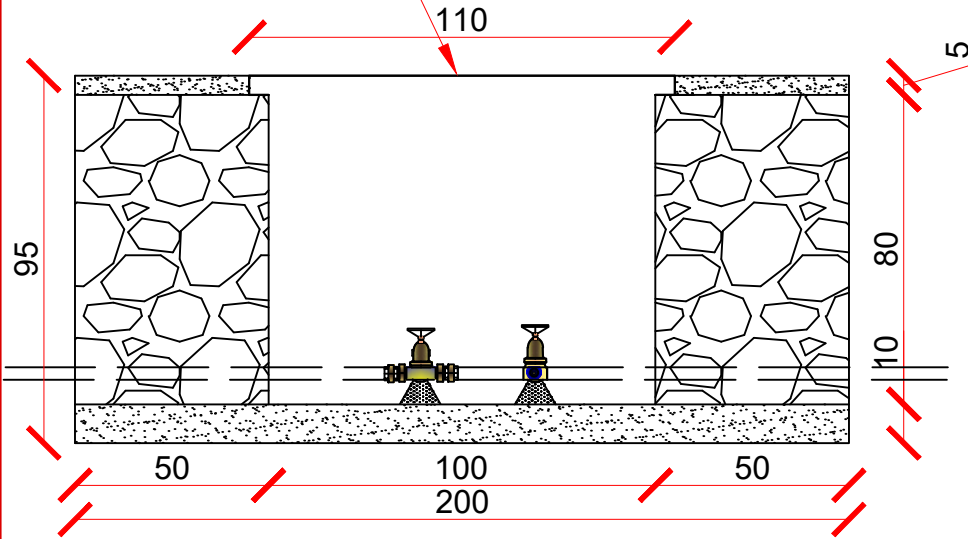

SECTION A - A

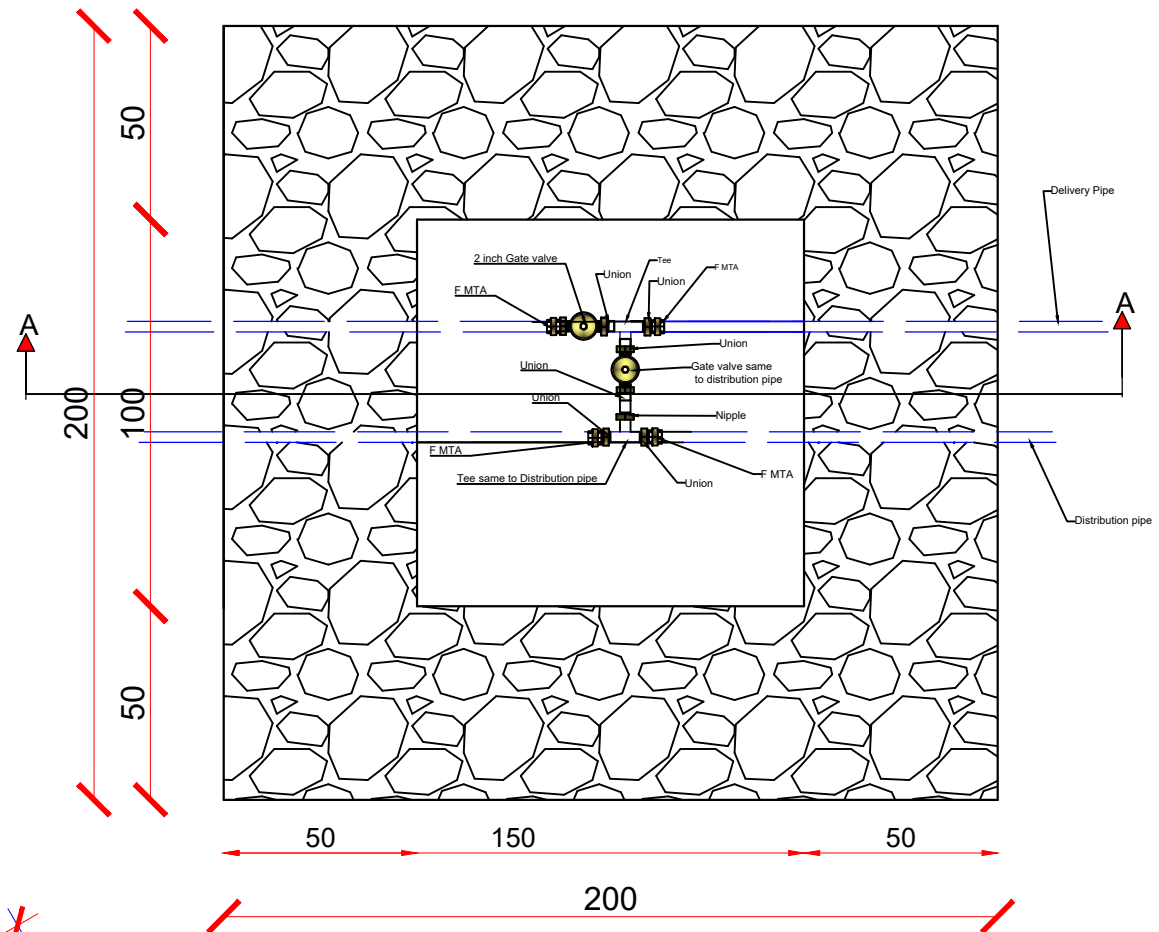
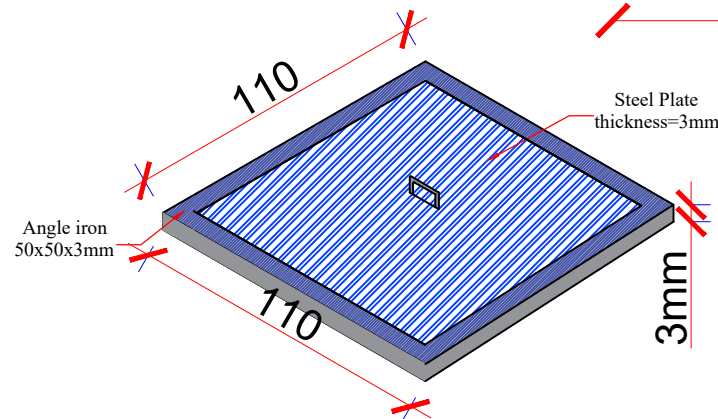
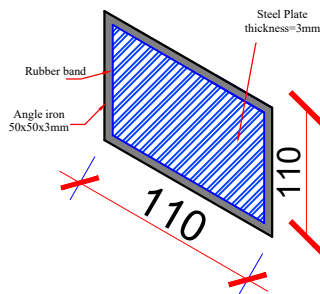

<b>MEDAIR</b> WASH <b>MEDAIR</b>	SURVEYED BY	MEDAIR Engineering Dep	CHECKED BY	Eng. Obaidullah Muneeb	SCALE	1:xx	SHEET NO. <div style="border: 1px solid black; border-radius: 50%; width: 30px; height: 30px; display: flex; align-items: center; justify-content: center;"> 1/1 </div>	PROVINCE	Urozgan	PROJECT NAME	<b>Water Supply System for Medair Health Facility (BHC) and Surrounding Community</b>
	DESIGNED BY	MEDAIR Engineering Dep	REVIEWED BY		DATE	Sep-2025		DISTRICT	Chinarto	WASH Project	
	DRAWN BY	WASH team	APPROVED BY		DRAWING NO			VILLAGE	Patan	DRAWING TITLE	
										Reservoir By Pass chamber	